

WONDERSTRIPES

Item-no.: 211-140, 211-141

Application of WONDERSTRIPES

Only a few steps are necessary to get a fresh and radiant look!

Important: The eyelid needs to be dry and must be cleansed and free from any oils! Cleanse your eyelids with toner or oil free makeup remover. Dab dry with cotton buds or a towel.

With a pair of tweezers or your fingernail remove one WONDERSTRIPES carefully from the film. The easiest way is when you slowly slide the nail under a corner of the strip. In this corner on the nail, the strip can easily be peeled off.



Tilt your head back and look straight into the mirror. In this position, your eyelid crease is best revealed. Depending on the shape of the eye and the texture of the skin apply the wonderstripe into the crease and press it gently down with two fingers.

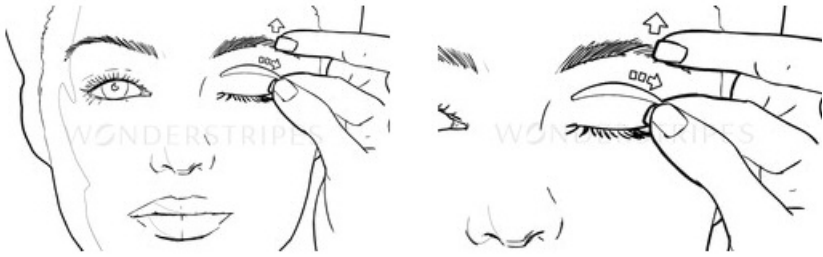

As each eye is different, there are no exact rules where to place WONDERSTRIPES accurately and which size (S or M) suits the eye best. A general advice is: small WONDERSTRIPES for normal, sagging eyes and large strips for drooping eyelids.

We recommend that you test both sizes during your first application before choosing the WONDERSTRIPES with the best effect.

At first you will need several patches to find the position that is right for you. Try to stick the strip lower, higher, more inwardly or outwardly. Be patient in your testing even if you have difficulties in the beginning. Please use always a new patch on your new attempt. To remove the used patch from your lid, find one end of the strip and pull it off gently.

When you are satisfied with the positioning of your WONDERSTRIPES, you can apply your make-up as per usual. However, be aware to gently dab eyeshadow onto your lid. Do not rub eyeshadow onto the patch!

Very important: Do not give up using WONDERSTRIPES if you encounter difficulties with your first application. WONDERSTRIPES can be used by women and men of all ages. Especially with tired, small eyes or drooping eyelids you can achieve great results within seconds!