

952-182



Pro·Idee

Leaf Chime

Item-no.: 226-497

ILLUMINO
LIGHT IN FORM

BRING YOUR WIND CHIME INTO FORM

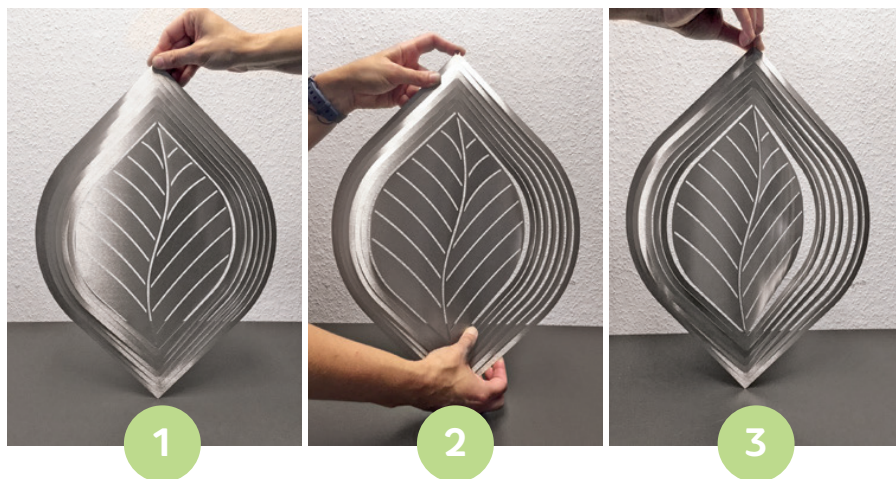

Press your wind chime from the inside out to bring it into the desired form (1/2). The individual metal rings must be pressed apart by approximately four millimetres to achieve the best effect (3).

Important notes about hanging up the ILLUMINO

Please make sure that the ILLUMINO is not exposed to excessively strong winds. It's also important that a nylon cord is used to hang the ILLUMINO and that this cord is replaced once a year for safety reasons. Keep the ILLUMINO away from children and do not place prams or cradles under the hanging ILLUMINO. No liability will be assumed for incorrect use.

Care information

Please clean the wind chime with standard window cleaners or in your dishwasher.