





We, as people, are constantly innovating, improving, and exploring,

We are enlightened by communication.

For long, language barrier has kept us in silent, in fear, and missing the opportunities.

With the creation of WT2 Plus,

Welcome to new era of foreign communication.

## Notice:

1. WT2 Plus is a special translation device. It can't listen to music or make phone calls.
2. WT2 Plus must be connected to mobile phones to support Bluetooth 4.2 and above protocols.
3. Recommended configuration for Android 7.0, iOS 11.0 and above after 2017.
4. It is recommended that you use a louder and clearer voice than usual to ensure the accuracy of translation.
5. It is recommended that you avoid using colloquial, slang, professional nouns and remote place names. If the translation is inaccurate, please change the way of expression.

## Product



01-Host



02-Guest



03-Charging Case



04-Charging Cable

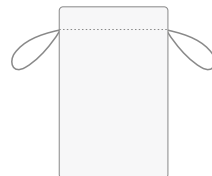

05-Carrying Bag



06-Ear-Hook



07-Earmuff

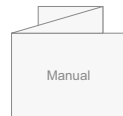

08-Manual

## Step 1: Download App

Please scan the QR code below, or search "WT2 Plus" in "App Store / Google Play" to download our App. The App requires network to work.



## Step 3: Connect to App

After you take out the earphones, LED indicators on both Earphones will flash green light, now go to "Device" page on App, and connect Earphones. When the connection completes, the LED indicators on both Earphones display solid green.

(WT2 Plus will automatically reconnect in your next use with its Connection-Memory function)

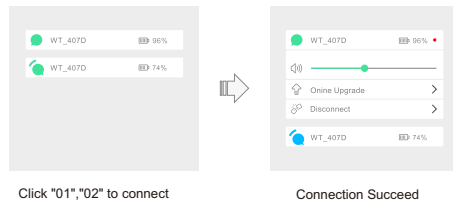

## Step 2: Take out Earphones

Open the charging case, take out the Earphones (01 Host, 02 Guest)

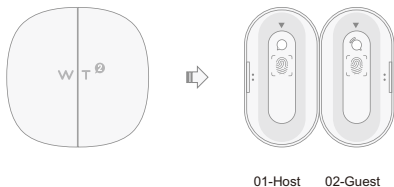

## Step 4: Share & Select Mode

Share Earphone (Guest) with the person you need to communicate, wear Earphone (Host) yourself.

Our App has three different communication modes to suit your needs.

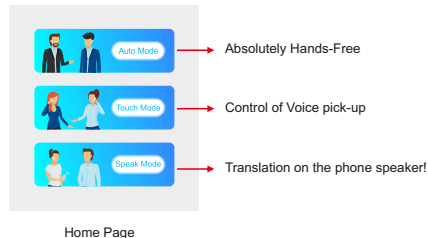

## Step 5: Set Language & Start

Ex. In Auto mode, choose the languages on the top of the page for both Earphones.



## Operational Teaching and Video

If you can't use WT2 products properly, you can find the instructions on the settings page in the mobile App.

Following the instructions, you can find your answers to the questions and follow the instructions to solve the problems and learn to use WT2 Plus.

We have also prepared operation teaching videos for you intimately. You can scan two-dimensional codes or enter a Web site to access video links and learn how to use WT2 Plus against the video.

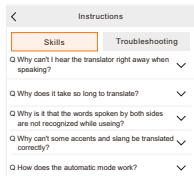

YouTube  
Video Links

## Charging

Earphones will automatically shutdown when putting back into charging case, charging will begin when LED indicator flash white light. At full charge, white light will disappear. It will take approximately 90 minutes for both charging case and the Earphones to be fully charged.

LED Indicator	What it means
No light	Sleep Mode
Green light flashing	Connect to App
Green light remain solid	Ready to use
Red light flashing / remain solid	Low battery
Blue light remain solid	Upgrading
White light remain solid	Charging

LED indicator



01-Host

02-Guest

## Charging and Indicator Lamp

We can know the current status of electricity from the flash mode of the charging box. When the headset is put into the charging box, the WT flash 4 times, representing the full power state, the rest of the state as shown in the figure below. When the headset is put into the charging box, the WT has no flash, which means that the battery is dead. Please plug in the Micro USB cable for charging.

100% W W W W W W W W  
75% W W W W W  
50% W W W  
25% W W

Charging Case Battery Level

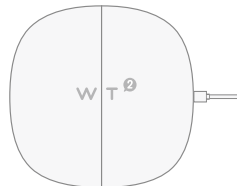

Charging with  
Micro USB Cable

## Safety

[Warning] Before you use, read the following instructions:

1. Please do not break, burn, penetrate, squeeze or expose to moisture.
2. Do not use unauthorized modification of circuits, and mismatch of the battery and charger.
3. Use manufacturer-authorized and matched accessories only. If you use other unauthorized and mismatched accessories may result in violation of the Warranty. Please contact us if you lose any accessories.
4. In order to prevent hearing impairment, do not often use the device in high-volume.
5. Please use the device between 0°C to 35°C, and keep storage temperature between -20°C to 45°C. Malfunction may occur with extreme temperatures.
6. Please keep the device away from high temperature or heating electronics such as, microwave and oven.
7. Do not replace the battery yourself.

Official Website: [www.timekettle.co](http://www.timekettle.co)

Customer Service: [support@timekettle.co](mailto:support@timekettle.co)

Manufacturer: Shenzhen Timekettle Technologies Co., Ltd

Address: Building 3, Minqi Science Park, Xili Street, Nanshan District, Shenzhen, Guangdong, China.

All copyrights reserved by Shenzhen Timekettle Technologies Co., Ltd.

This manual is for reference only, do not constitute any form of commitment.