



CE Declaration of Conformity
 This device features radio interference suppression
 in compliance with valid EC Regulation 2004/108

Note: The displayed value may be adversely affected under extreme electromagnetic influences, e.g. when using a radio unit in the immediate vicinity of the device. Once the interference has been rectified, the product can once again be used for its intended purpose. The device may have to be switched-on again.

Statutory instructions on battery disposal

Batteries must not be disposed as household waste. The law requires that you, as consumer, return the wasted batteries either to public collection points in your town or village or to any outlet selling batteries of the same kind.

Note:



Batteries are marked as follows:
 Li = Battery contains Lithium
 Al = Battery contains Alkali
 Mn = Battery contains Manganese

CR (Li); AA (Al, Mn); AAA (Al, Mn)

Safety instructions for lithium batteries (CR2032/CR2430):

1. Lithium batteries are lithium manganese cells. If you do not use the scale over a longer period, you should take out the batteries of the device.
2. Never open the lithium battery, do not put into fire, or expose to shocks because an explosion risk lasts or discharge of poisonous exposure to fumes might possible.
3. Never touch leaked cells with bare hands.
4. When eyes or hands are contaminated, it is essential to rinse with lots of water. You should go to a doctor if skin or eyes are irritated.
5. Dispose cells only completely discharged or protected against polarity reversal wrapped according to your local disposal regulation.
6. Do not expose the cells to direct solar radiation and store away from heat; otherwise, there is risk of overheating.
7. Maintain a storage temperature of < 40°C.

Disposal of old electrical and electronic equipment



This symbol on the product or on its packaging indicates that this product shall not be treating as household waste. Instead, it shall be hand over to the applicable collection point for recycling of electrical and electronic equipment. For more detailed information's about recycling please contact your local city office, your household waste disposal service or the shop where you purchased the product.

With kind regards

ADE (GmbH & Co.)



Model Franca / KE 919
Instruction Manual



Contents

1. Preparation for use.....	Page 2
2. Handling.....	Page 2
3. Error Messages.....	Page 3
4. Technical Data.....	Page 3
5. Warranty.....	Page 3



TARE FUNCTION



AUTO OFF



LIQUIDS



BATTERY LEVEL

Thank you for your decision to purchase this high quality product of ADE Germany. You bought a scale featuring highest technical standard and well-proven quality. Please read this instruction manual prior to the start up and keep it careful to have this information on hand whenever needed.

1. Preparation for use

Activate / Replace batteries:

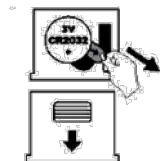

Open the battery cover at the bottom side of the scale and remove the battery safety strip. Please ensure the correct polarity of the battery (+/-).

To replace the battery open the battery cover. Move the battery at the recess downwards and the battery will be easy to take out. Make sure that you do not bend the contact. Insert the new battery (1 x CR2032) and close the battery cover.

Safety guidelines:



Please care that no heavy object may fall on the scale. Otherwise, the scale may become damage.



Clean the scale only by using a slightly damp cloth. Do not use solvents or abrasive cleaning agents. Do not submerge the scale under water. All plastic parts of the scale should be cleaned immediately after contact with fat, spices, vinegar and other heavily spiced or coloured food. Avoid contact with citric acid.

To remove the measuring cup (e.g. for cleaning) push the pushbutton below the handle and remove the measuring cup.

2. Handling

Switch-on the scale:

To switch-on the scale push the ON/OFF/TARE-button. At first, the LCD display will show for a few seconds the characters "8888" and after the scale leveled off, the indication will be "0 g". Now the scale is ready to use.

Units of weight:

By pushing the UNIT/HOLD-button it is possible to change the unit of weight for country specific setting (g = gram / lb:oz = pound ounce / ml = millilitre / fl.oz = fluid ounce). Please pay attention to use the scale under consideration of your country specific unit of weight.

Weighing:

Switch-on the scale. After the 0 g indication is stable put the weighing charge into the measuring cup. After stabilisation of the weight indication, the weight is readable in the display.

Hold-function:

By pushing the UNIT/HOLD-button, while the weight indication is stable you can hold the reading. When Hold-function is active, the symbol "H" appears in the display. To deactivate the Hold-function push the UNIT/HOLD-button again.

Tare-function:

Use the ON/OFF/TARE-button to set the scale to "0 g". Put the weighing charge into the measuring cup. Upon the weight is indicated and stable push the ON/OFF/TARE-button to set the indication again to zero. This process is repeatable until the max. capacity of the scale (3 kg) has been reached. After removal of the loading, the display indicates the total weight as negative reading. Please take care not to move the weighing platform during the tare procedure.

Automatic switch-off the scale:

If the indicated weight does not change within 90 seconds, the scale will automatically switch-off. To save the battery you can switch-off the scale manually by pushing the ON/OFF/TARE-button for about 2 seconds.

3. Error Messages

"LO"	=	Battery is used up - Please replace the battery with the intended type (1 x CR2032).
"Err"	=	Overload - The weight exceeds the maximum capacity of 3 kg. Please immediately remove the critical load to avoid load cell damage.

4. Technical Data

Capacity x graduation:	max. 3 kg x 1 g
Max. volume measuring cup:	1 litre
Dimensions:	195 mm x 147 mm x 130 mm
Battery:	1 x CR2032 (included)

Subject to technical modifications

5. Warranty

ADE warrants for a period of 2 years from the date of purchase that it will remedy any defects due to faulty material or workmanship free of charge by repair or replacement. When making a guarantee claim, please return the weighing scale together with the sales slip including the reason of complaint to your dealer.